

2024



A FLOW architecture

Content

01	WHY AFLOW	04
02	SERVICES	05
03	REFERENCES & EXPERIENCE	09
04	WHO IS AFLOW	13
05	PRIOR TO AFLOW	14

01 | Why AFLOW

AFLOW brings the same attention and methodical approach to small-scale renovations as well as to larger-scale projects, because it is aware of their impact on the lives of the people who will benefit from them. From the general design, to the detailing and interior fittings, we take care of all aspects.

You search

- + A partner you can trust
- + A partner who listens to YOUR needs and desires
- + An experienced partner
- + Quality results within budget

We offer

- + A partnership based on trust and respect
- + A process where YOUR project is at the centre
- + Extensive domain knowledge
- + A high-quality, optimised project

02 | Services

Thanks to its experience in large-scale and complex projects, AFLOW is able to offer you a wide range of skills for any need and any scale of project.

Architectural project

Architectural services according the SIA 102 regulation:

- + Clarification of the objectives
- + Preliminary studies development
- + Project development (from conception to execution)
- + Planning permission procedures
- + Architectural supervision during the execution
- + Architectural supervision during the delivery phase

AFLOW works closely with its partners for :

- + Invitation to tender
- + Construction management

Project management

- + Cost monitoring and financial management
- + Planning
- + Interdisciplinary coordination
- + Interface with the authorities
- + Represent the Client

Consulting

- + Consulting in preparation to a feasibility study
- + External consulting for an ongoing project
- + Technical consulting
- + Healthcare buildings consulting
- + Public buildings consulting
- + Visualise the potential !
- + Online consulting

All our services →

Architectural project

AFLOW provides a full range of architectural services from concept to construction. This can include developing your design brief, developing a feasibility study, submitting a planning application, drawing up construction documents and managing the construction process.

AFLOW works with teams of contractors and specialists to achieve the desired results.

AFLOW is a SIA- and REG-A-accredited architectural practice and uses the SIA standard to develop, manage and implement projects.

Depending on your needs, AFLOW can take charge of some, several or all of the following tasks:

- + **Definition of objectives**
- + **Preliminary studies**
- + **Project study (from conception to completion)**
- + **Administrative follow-up**
- + **Technical coordination**
- + **Preparation for execution**
- + **Execution follow-up**
- + **Commissioning**



Project management

AFLOW can manage the project by establishing a delivery schedule, managing costs and coordinating consultants and contractors. Thanks to our extensive experience in complex projects, we can anticipate problems before they arise to ensure that your project runs smoothly: as these are technical aspects, and often quite sensitive, getting a head start on them can make all the difference for the smooth execution of the project.

- + **Monitoring costs**
- + **Planning**
- + **Coordination**
- + **Administrative support**

Administration

Whatever the scale or type of your project, it is essential that it fits into its context and complies with legal requirements. These are often lengthy and highly technical procedures which, if poorly managed, can lead to unpleasant surprises. AFLOW takes care of these procedures to ensure that your processes are as streamlined, simple and transparent as possible.

- + **Link with authorities for the procedures**
- + **Requests for tenders**
- + **Grant applications**
- + **Administrative follow-up**
- + **Client representation**

Consulting

Having a clear idea and strategy is of the utmost importance for a smooth progress of the project. Whether it is a small private renovation or a large public project, AFLOW offers its experience to help you clarify your needs and build a vision for the future.

- + PRELIMINARY ADVICE
- + ONGOING ADVICE
- + TECHNICAL ADVICE

Online consulting

With this remote consultancy service, AFLOW wishes to support all those who are faced with changes and/or who feel the need to make changes to their living or working environment. Even for the smallest projects, the support of an architect will add value, clarify your choices, minimise risks and optimise implementation time.



We design
beyond **architecture.**

We design
human **experiences.**

03 | References

Baita 2.0

Chalet renovation
Blonay (VD) - Switzerland - 2021

More information



03 | References

Penthouse

Hotel renovation
Saas-Fee (Valais) - Switzerland - 2021 / 22

More information



03 | References

School site

Competition
Jongny (Vaud) - Switzerland - 2023

More information →

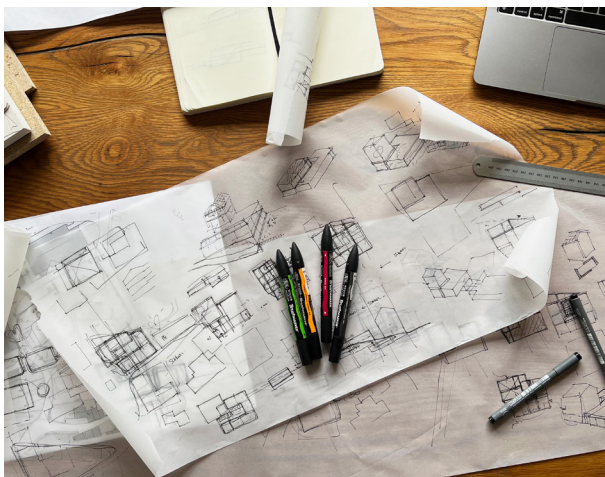

03 | References

Interior

Interior design
Switzerland - 2021 / 23

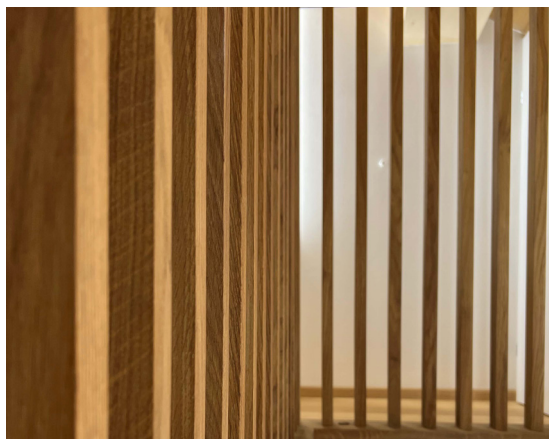

04 | Who is AFLOW

AFLOW offers a wide range of experience and skills using a SIMPLE and EFFECTIVE architectural process.

Who

Working as an architect since 2006, Giada has extensive experience in the international architectural sector and has a deep understanding of the challenges and requirements of projects of all sizes.

In 2021, Giada decided to launch AFLOW with the aim of putting her experience and skills at the service of a HUMAN-CENTERED, ACCESSIBLE, OPEN and EFFICIENT architectural process.

Born in Italy, she lives in Switzerland since 2011. She has studied in Genoa, Paris and London and worked in London and Lausanne.

Giada is fluent in English, French and Italian.

The method

With over 17 years of experience in the architecture sector, mainly as a team and project leader, Giada has an in-depth knowledge of the challenges and issues of architectural projects, whatever the size.

This methodology and vision have found their expression in AFLOW, which is therefore characterised by the combination of the more human aspects and openness to the needs of others. This, in combination with the pragmatism, efficiency, experience, creativity and leadership are the keys to face the challenges of any project.

With a long experience in the international architecture industry, we fully understand the challenges and requirements of projects of all sizes.



Giada Pilo

Founder of AFLOW architecture Sàrl and architect SIA/REG-A

2021

AFLOW architecture (CH)

2019 - 2021

Itten + Brechbuehl, Lausanne (CH)

2015 - 2019

CHUV - Direction des Constructions, Lausanne (CH)

2011 - 2015

Itten + Brechbuehl, Lausanne (CH)

2006 - 2011

Foster + Partners, London (UK)

2020

Affiliation SIA et REG-A (CH)

2007 - 2017

Affiliation ARB (UK)

2006

Affiliation Professional register (IT)

2005

Master in architecture

2004 - 2005

UEL, University of East London, Architecture (UK)

2003 - 2004

Ecole d'architecture de Paris Belleville (FR)

1999 - 2003

Università degli Studi di Genova, architecture (IT)

05 | Prior to AFLOW

Giada has a wide range of experience, resulting from involvement in a large variety of projects since 2005.

Small

Chambres du futur, Clinique de la Source
Lausanne (CH), Itten + Brechbuehl, 2018/19

Musées des arts, Bab al Bahr
Rabat (Marocco), Foster + Partners, 2008/10

Transformation pour centre d'addictologie - CHUV
Lausanne (CH), MO-CHUV, 2016

Medium

Competition Blue Factory
Fribourg (CH), Itten + Brechbuehl, 2018/19

Transformation of the maternity hall - CHUV
Lausanne (CH), MO-CHUV, 2016/17

Extension of the Sylvana Clinic - CHUV
Epalinges (CH), MO, CHUV, 2015/17

Unité d'hospitalisation individuelle, BH19, CHUV
Lausanne (CH), MO, CHUV, 2015/17

Large

Chaplin museum
Corsier sur Vevey (CH), Itten + Brechbuehl, 2013/14

Competition, CHUV Children hospital
Lausanne (CH), Itten + Brechbuehl, 2013

Competition, school site
Nyon (CH), Itten + Brechbuehl, 2013

Salle de Médran
Verbier (CH), Itten + Brechbuehl, 2011/13

Tai Po Luxury Resort
Hong Kong, Foster + Partners, 2008

XLarge

Tilia Tower
Prilly (CH), Itten + Brechbuehl, 2021

Aminona luxury resort
Aminona (CH), Itten + Brechbuehl, 2018/20

Slussen, masterplan
Stockholm (Sweden), Foster + Partners, 2010/11

Russian Land Tower
Moscou (Russia), Foster + Partners, 2008

New Holland Island
Saint-Pétersbourg (Russia), Foster + Partners, 2006/08

Competition, Barangaroo, Est Darling Harbour
Sydney (Australie), Foster + Partners, 2008

Competition, Jiangsu Grand Theatre
Nanjing (China), Foster + Partners, 2010/11

VietinBank HQ
Hanoi (Vietnam), Foster + Partners, 2010

